

# SPHOORTI

*Precision Assured*

## BMT TOOL HOLDERS

FOR CNC TURN MILL CENTER



BMT Tool Holders Assembly With Turrets

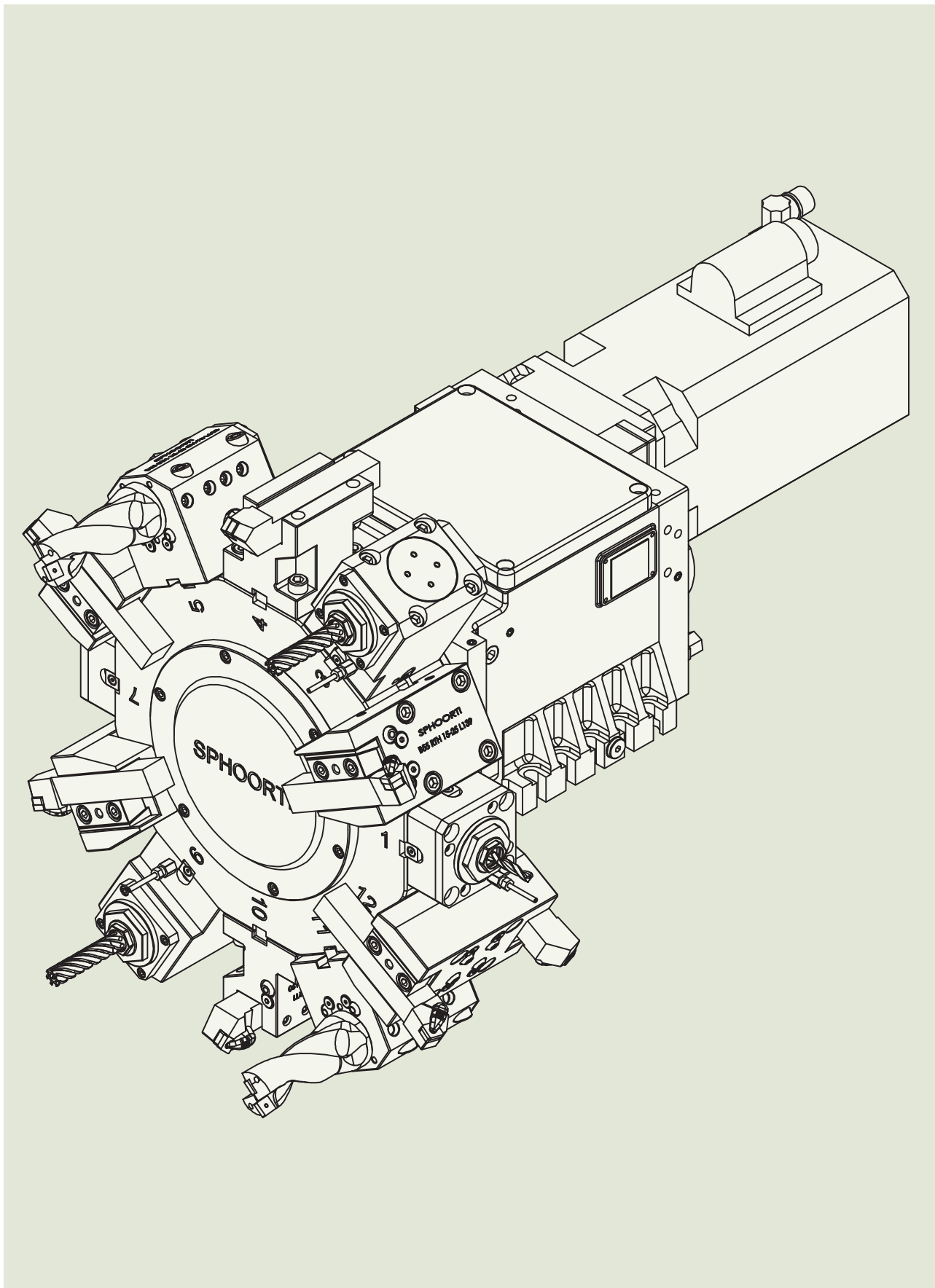

**BMT DRIVEN TOOL HOLDERS**

**COMPATIBLE WITH:**

- DUPLOMATIC
- DOOSAN
- HARDINGE
- HWACHEON
- HYUNDAI WIA
- SAMSUNG
- VICTOR

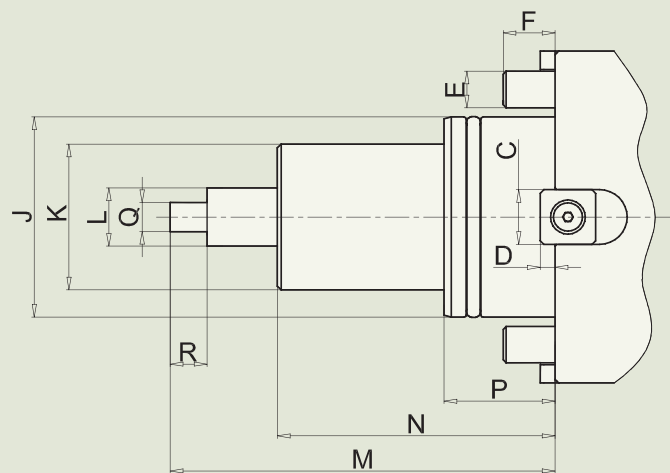
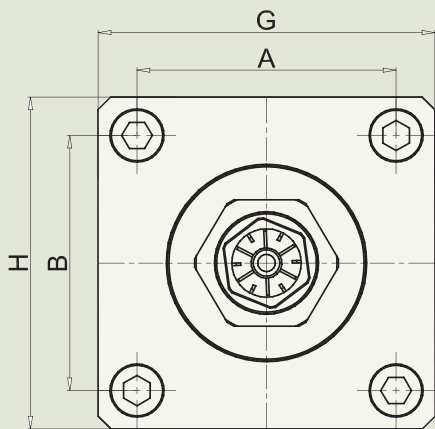
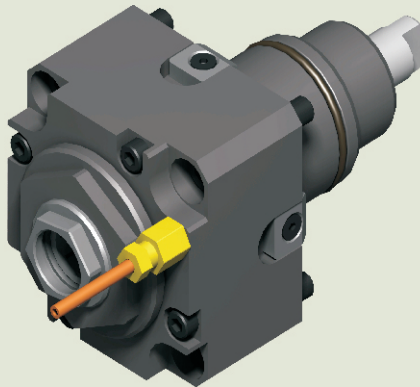
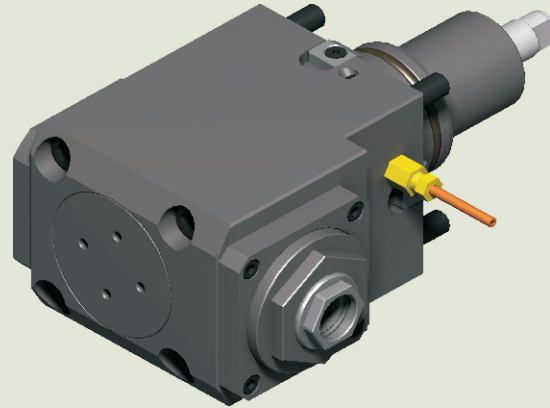

CODE	A	B	C	D	E	F	G	H	J	K	L	M	N	P	Q	R
BMT45	58	58	15	4	M8	10	75	75	45	35	14	84	60	40	6	8.5
BMT55	64	64	15	4	M10	14	85	85	55	40	16	104	75	30	8	8.5
BMT65	70	73	18	5	M12	15	94	94	65	45	18	112	83	32	10	14
BMT75	90	90	25	5	M12	15	112	112	75	55	23	110	80	43	14	15

**AXIAL TOOL HOLDERS - B45**

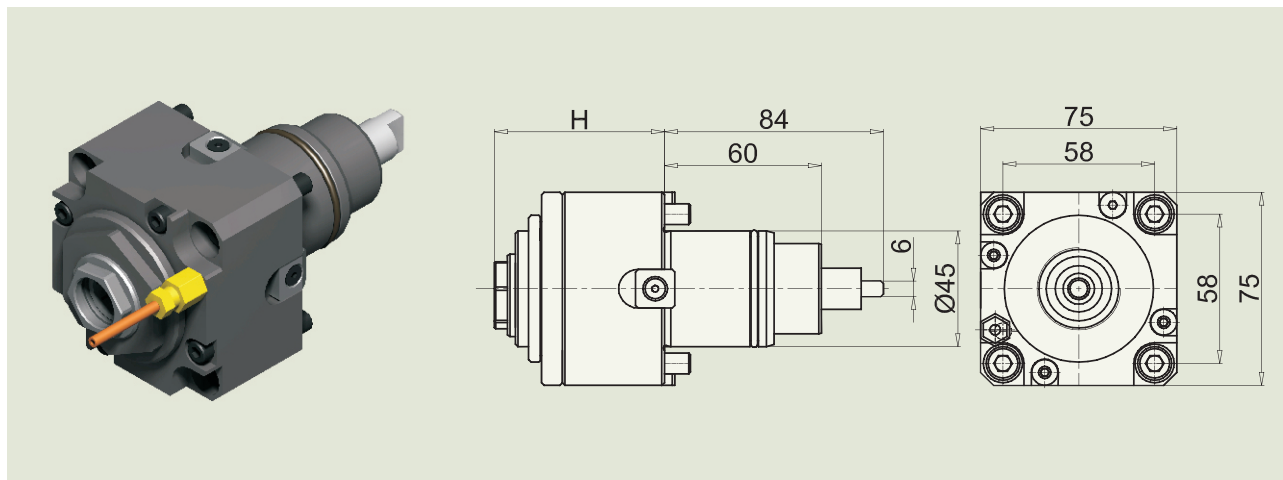

<b>INTERNAL NUT</b>			<b>RATIO 1:1</b>		
CODE	ITEM ID	Output	Internal Coolant	H	RPM
B45-ATH ER25 DIN1809 INT.NUT	SD7014	ER-25 Ø1-16	No	65	6000

**RADIAL TOOL HOLDERS - B45**

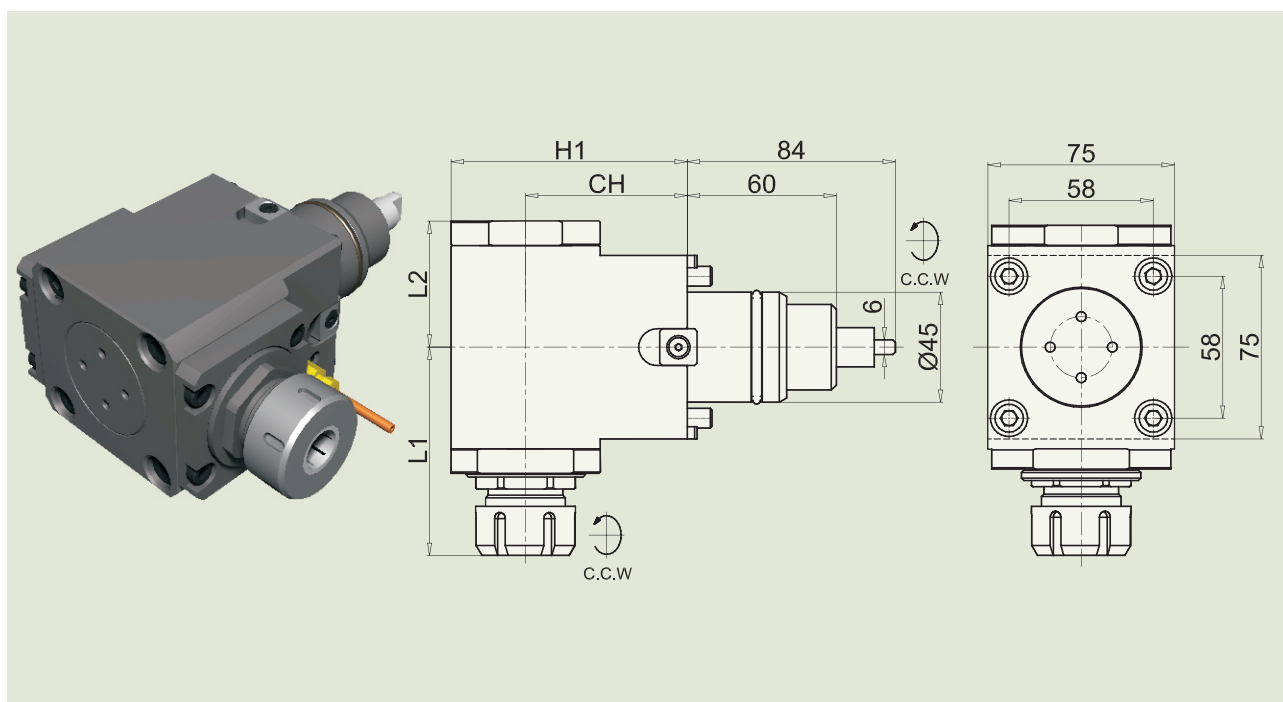

<b>EXTERNAL NUT</b>					<b>RATIO 1:1</b>				
CODE	ITEM ID	Output	Internal Coolant	CH	H1	L1	L2	RPM	
B45-RTH ER25 CH-65 DIN1809	SD7015	ER-25 Ø1-16	No	65	95	85	51.5	6000	

\* BMT Driven tool Holders can be supplied as per customer drawing



**AXIAL TOOL HOLDERS - B55**

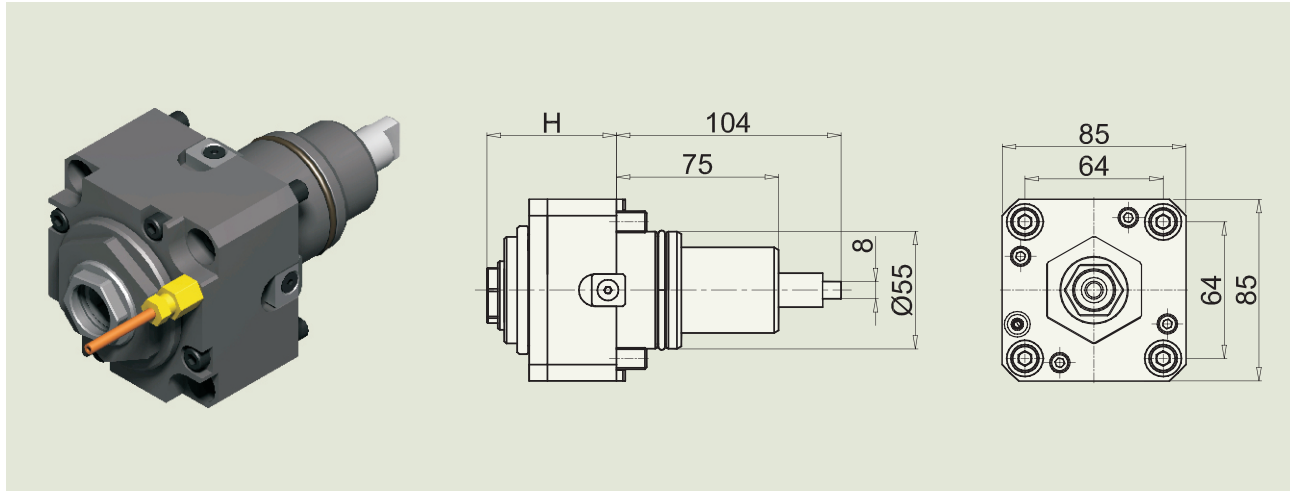

<b>INTERNAL NUT</b>					<b>RATIO 1 : 1</b>	
CODE	ITEM ID	Output	Internal Coolant	H	RPM	
B55-ATH ER25 DIN1809 INT.NUT	SD7116	ER-25 Ø1-16	No	60	6000	
B55-ATH ER32 DIN1809 INT.NUT	SD7114	ER-32 Ø2-20	No	77	6000	

**RADIAL TOOL HOLDERS - B55**

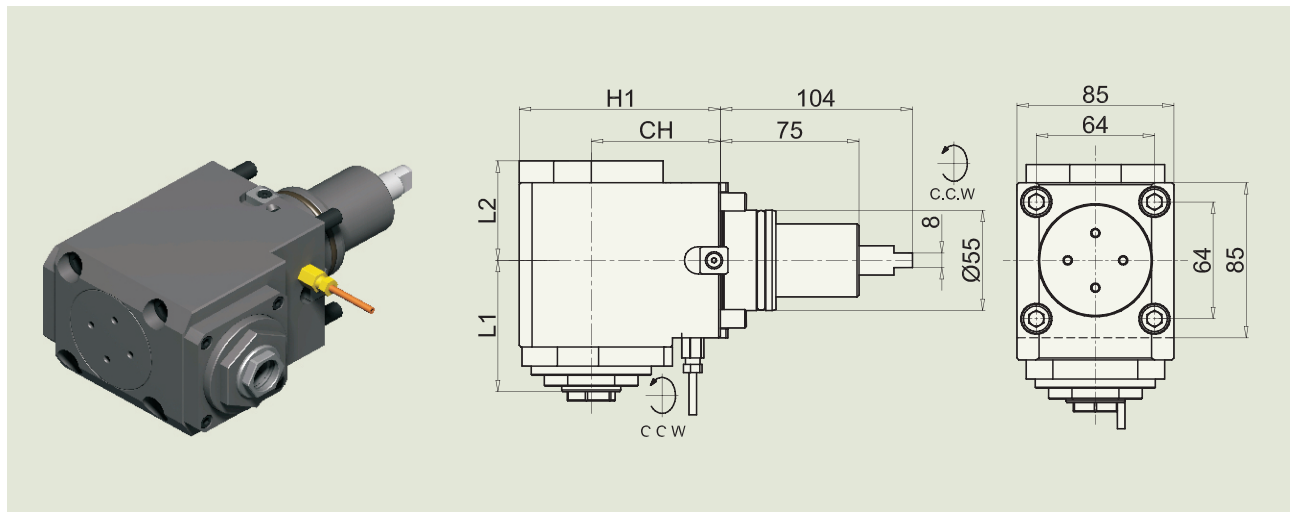

<b>INTERNAL NUT</b>					<b>RATIO 1 : 1</b>				
CODE	ITEM ID	Output	Internal Coolant	CH	H1	L1	L2	RPM	
B55-RTH ER25 CH-70 DIN1809 INT.NUT	SD7112	ER-25 Ø1-16	No	70	104	76	52.5	5500	
B55-RTH ER32 CH-70 DIN1809 INT.NUT	SD7115	ER-32 Ø2-20	No	70	104	76	52.5	5500	
B55-RTH ER25 CH-85 DIN1809 INT.NUT	SD7118	ER-25 Ø1-16	No	85	119	76	52.5	5500	
B55-RTH ER32 CH-85 DIN1809 INT.NUT	SD7117	ER-32 Ø2-20	No	85	119	76	52.5	5500	

\* BMT Driven tool Holders can be supplied as per customer drawing

**AXIAL TOOL HOLDERS - B65**

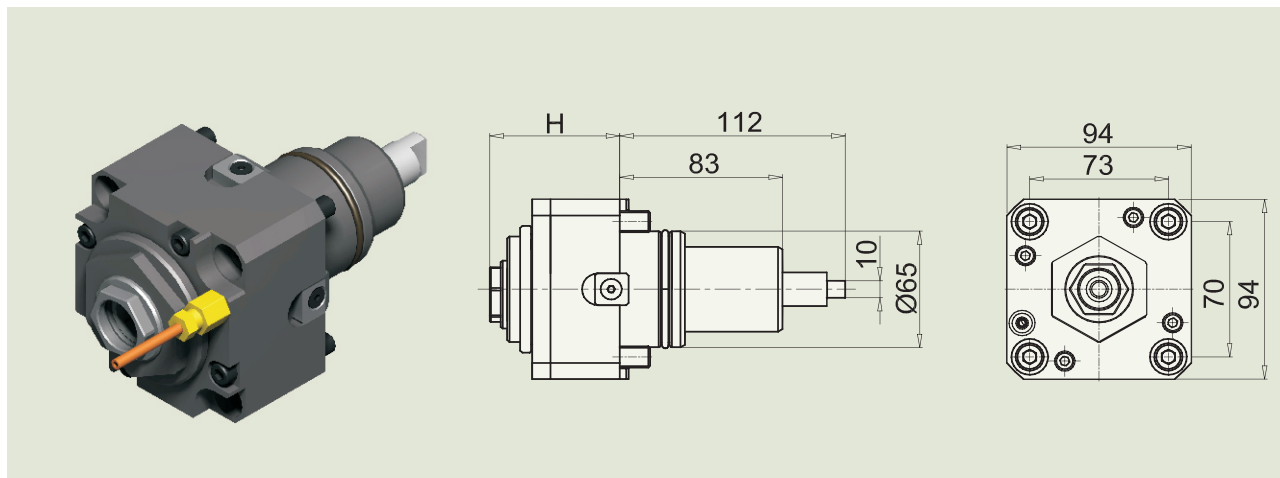

INTERNAL NUT		RATIO 1:1
--------------	--	-----------

CODE	ITEM ID	Output	Internal Coolant	H	RPM
B65-ATH ER32 DIN1809 INT.NUT	SD7204	ER-32 Ø2-20	No	66	5000

**RADIAL TOOL HOLDERS - B65**

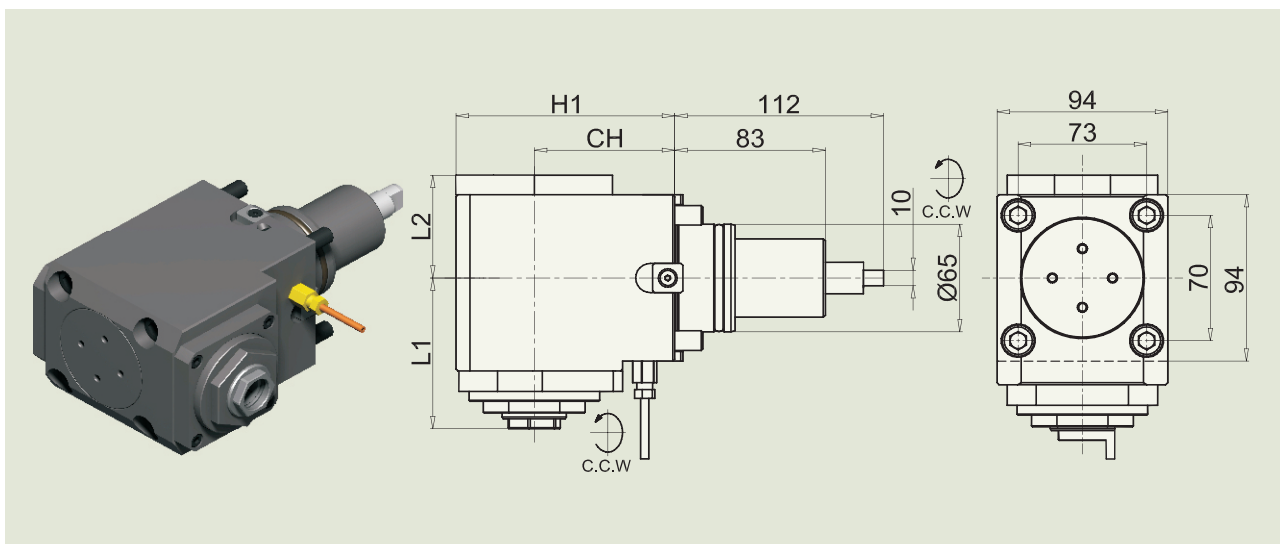

INTERNAL NUT		RATIO 1:1
--------------	--	-----------

CODE	ITEM ID	Output	Internal Coolant	CH	H1	L1	L2	RPM
B65-RTH ER32 CH-72 DIN1809 INT.NUT	SD7211	ER-32 Ø2-20	No	72	110	83	61	5000
B65-RTH ER32 CH-90 DIN1809 INT.NUT	SD7210	ER-32 Ø2-20	No	90	128	83	61	5000
B65-RTH ER32 CH-100 DIN1809 INT.NUT	SD7212	ER-32 Ø2-20	No	100	138	83	61	5000

\* BMT Driven tool Holders can be supplied as per customer drawing

**AXIAL TOOL HOLDERS - B75**

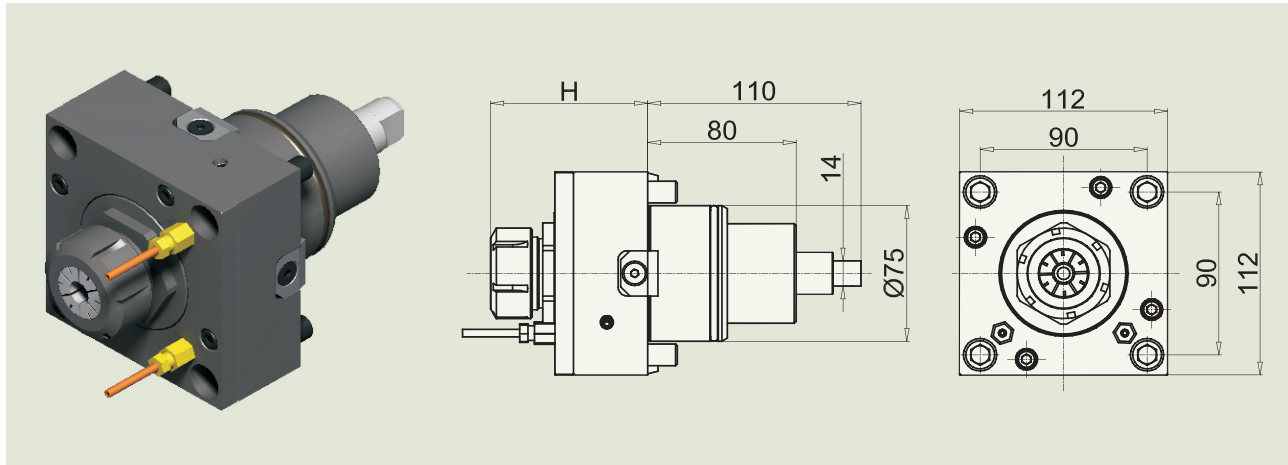

<b>EXTERNAL NUT</b>					<b>RATIO 1:1</b>	
CODE	ITEM ID	Output	Internal Coolant	H	RPM	
B75-ATH ER32 DIN1809	SD7301	ER-32 Ø2-20	No	85	8000	
B75-ATH ER40 DIN1809	SD7303	ER-40 Ø3-30	No	90	8000	

**RADIAL TOOL HOLDERS - B75**

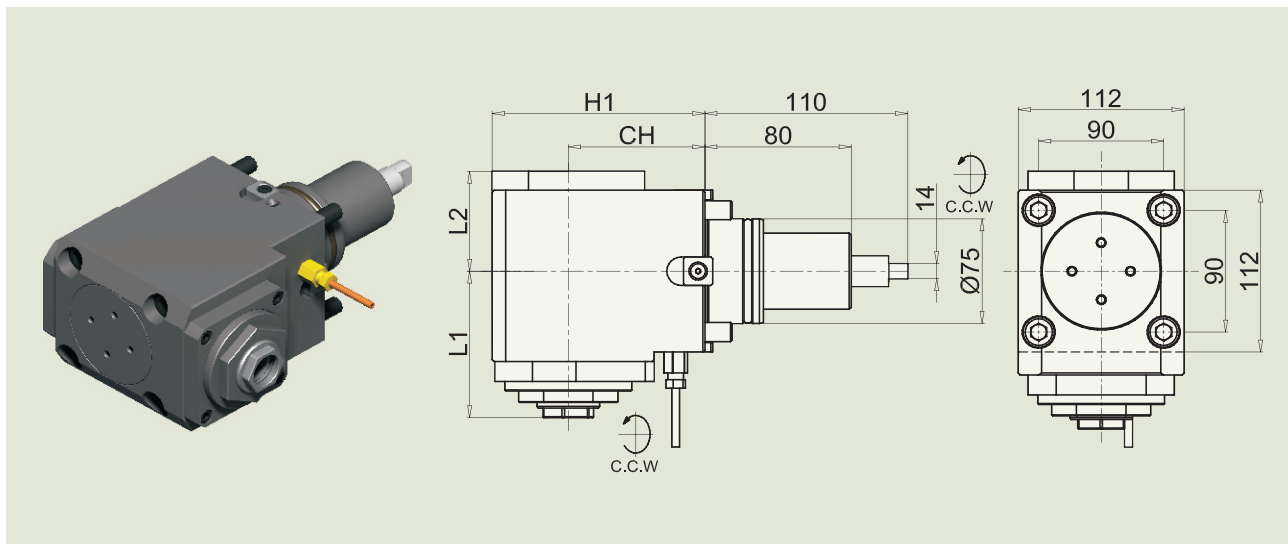

<b>INTERNAL NUT</b>					<b>RATIO 1:1</b>				
CODE	ITEM ID	Output	Internal Coolant	CH	H1	L1	L2	RPM	
B75-RTH ER40 CH-60 DIN1809 INT.NUT	SD7305	ER-40 Ø3-30	No	60	105	98	65.5	4000	
B75-RTH ER40 CH-80 DIN1809 INT.NUT	SD7307	ER-40 Ø3-30	No	80	125	98	65.5	4000	

\* BMT Driven tool Holders can be supplied as per customer drawing

**AXIAL TOOL HOLDER TYPE-1**

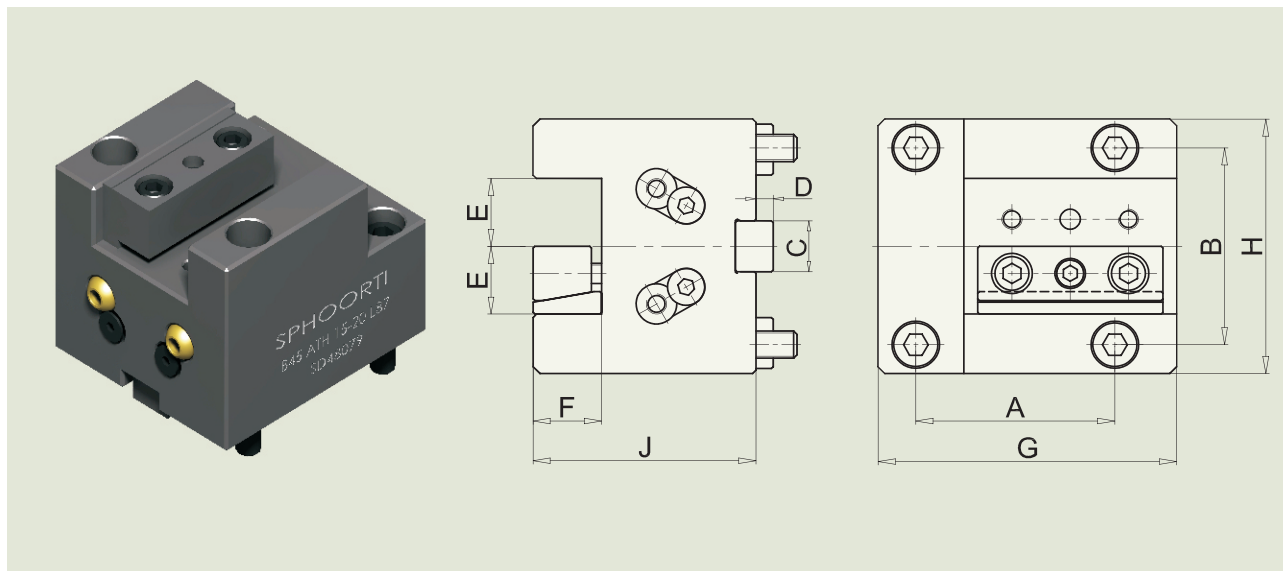

CODE	ITEM ID	A	B	C	D	E	F	G	H	J
B45-ATH 15-20 L87	SD48079	58	58	15	5	20	20	87	75	65
B45-ATH 15-20 L103	SD48235	58	58	15	5	20	20	103	75	60
B55-ATH 15-20D L90	SD48347	64	64	15	5	25	25	90	86	95
B65-ATH 18-25 L125	SD48069	70	73	18	5	25	25	125	96	93
B75-ATH 25-25 L140	SD48002	90	90	25	6	25	25	140	112	70
B85-ATH 25-32 L156	SD48253	100	100	25	6	32	32	156	130	90

**AXIAL TOOL HOLDER TYPE-2**

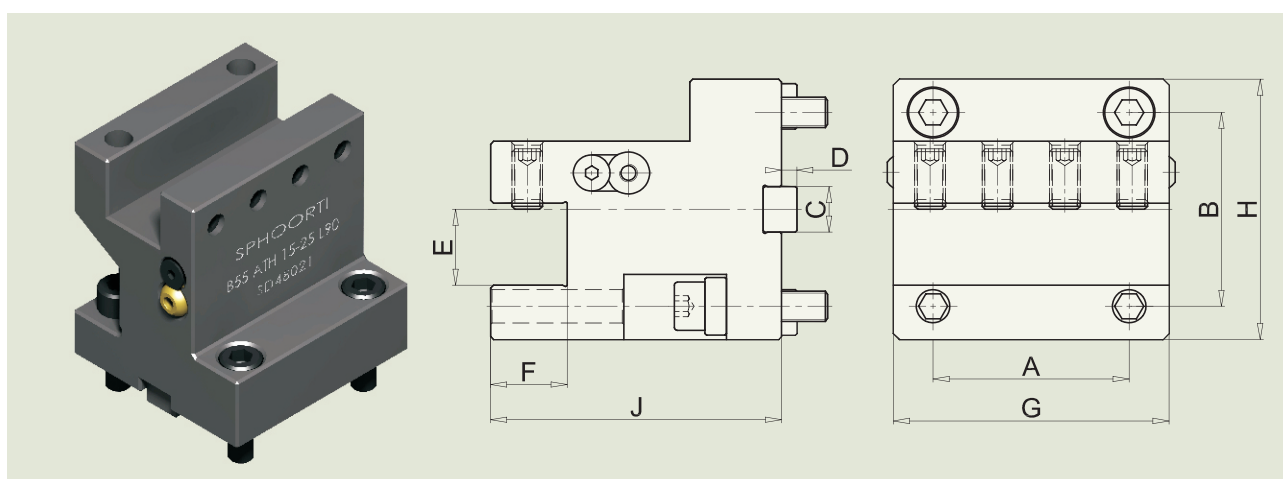

CODE	ITEM ID	A	B	C	D	E	F	G	H	J
B55-ATH 15-25 L90	SD48021	64	64	15	5	25	25	90	86	95
B65-ATH 18-25 L115	SD48026	70	73	18	5	25	25	115	96	95

\* BMT Static tool Holders can be supplied as per customer drawing



**BORING TOOL HOLDERS**

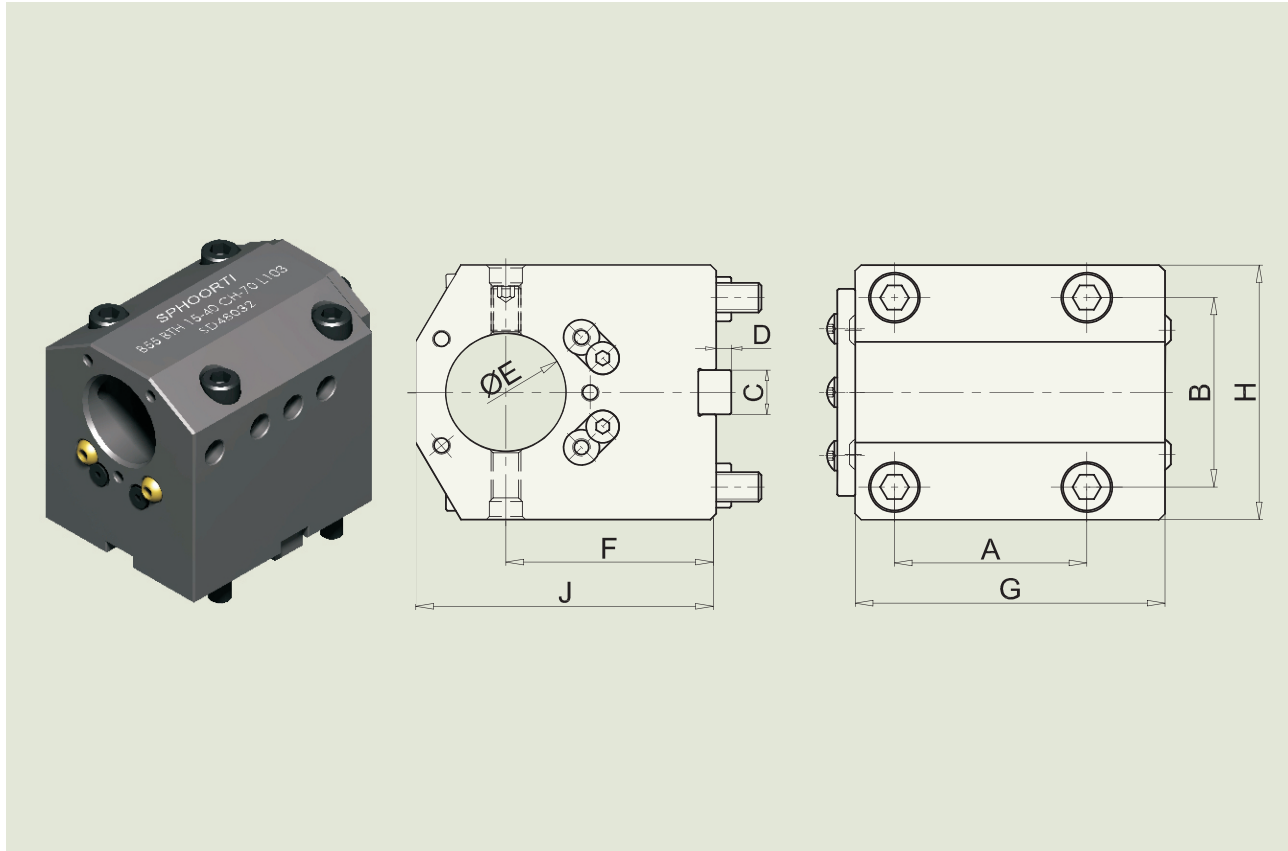

CODE	ITEM ID	A	B	C	D	ØE	F	G	H	J
B45-BTH 15-32 CH65 L80	SD48049	58	58	15	5	32	65	80	75	95
B45-BTH 15-32 CH65 L140	SD48262	58	58	15	5	32	65	140	75	95
B45-BTH 15-32 CH85 L80	SD48341	58	58	15	5	32	85	80	75	115
B55-BTH 15-40 CH60 L103	SD48019	64	64	15	5	40	60	103	86	90
B55-BTH 15-40 CH70 L103	SD48032	64	64	15	5	40	70	103	86	100
B55-BTH 15-40 CH100 L103	SD48020	64	64	15	5	40	100	103	86	130
B65-BTH 18-40 CH72 L127	SD48025	70	73	18	5	40	72	127	96	102
B65-BTH 18-40 CH100 L127	SD48033	70	73	18	5	40	100	127	96	135
B65-BTH 18-40 CH115 L127	SD48027	70	73	18	5	40	115	127	96	150
B75-BTH 25-50 CH60 L165	SD48004	90	90	25	6	50	60	165	112	110
B75-BTH 25-60 CH60 L165	SD48003	90	90	25	6	60	60	165	112	110
B75-BTH 25-60 CH90 L165	SD48256	90	90	25	6	60	90	165	112	135
B85-BTH 25-80 CH60 L195	SD48255	100	100	25	6	80	60	195	130	117
B85-BTH 25-80 CH85 L195	SD48046	100	100	25	6	80	85	195	130	142

\* BMT Static tool Holders can be supplied as per customer drawing

**RADIAL TOOL HOLDER TYPE-1**

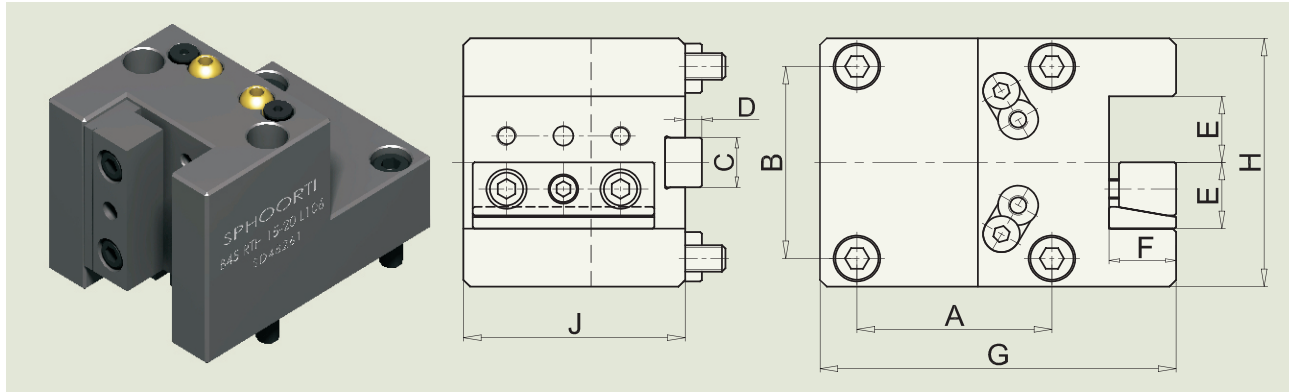

CODE	ITEM ID	A	B	C	D	E	F	G	H	J
B45-RTH 15-20 L102	SD48078	58	58	15	5	20	20	102	75	66
B45-RTH 15-20 L106	SD48261	58	58	15	5	20	20	106	75	66
B55-RTH 15-20 L104	SD48433	64	64	15	5	20	20	104	86	73
B65-RTH 18-25 L130	SD48024	70	73	18	5	25	25	130	96	75
B65-RTH 18-25 L104	SD48073	70	73	18	5	25	25	104	96	75
B75-RTH 25-25 L145.5	SD48434	90	90	25	6	25	25	145.5	112	85
B75-RTH 25-32 L150.5	SD48435	90	90	25	6	32	32	150.5	112	85
B85-RTH 25-32 L168.5	SD48436	100	100	25	6	32	32	168.5	125	90

**RADIAL TOOL HOLDER TYPE-2**

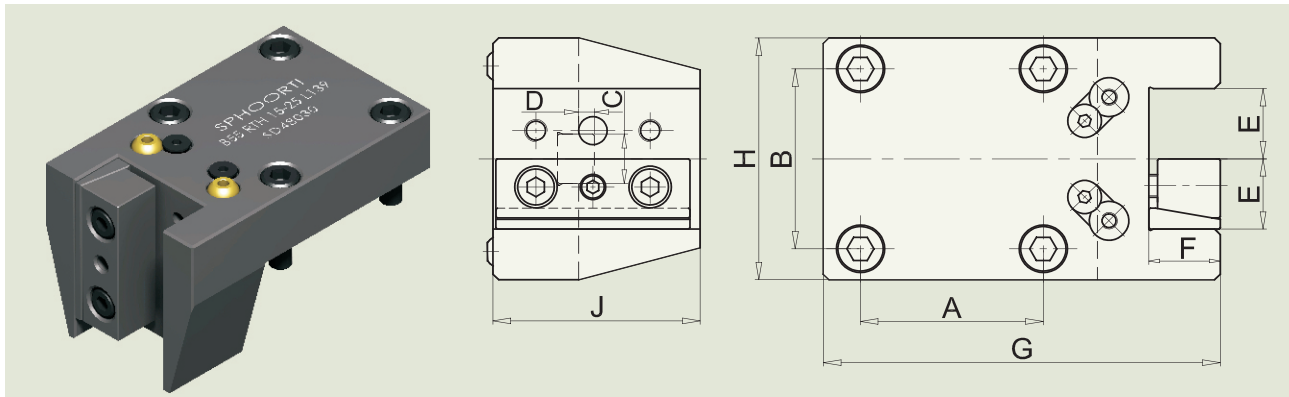

CODE	ITEM ID	A	B	C	D	E	F	G	H	J
B45-RTH 15-20 L127	SD48258	58	58	15	5	20	20	127	75	66
B55-RTH 15-25 L139	SD48030	64	64	15	5	25	25	139	86	80
B65-RTH 18-25 L150	SD48437	70	73	18	5	25	25	150	96	75
B75-RTH 25-25 L165	SD48001	90	90	25	6	25	25	165	112	100
B75-RTH 25-32 L168	SD48005	90	90	25	6	32	32	168	112	100
B85-RTH 25-32 L192	SD48241	100	100	25	6	32	32	192	130	140

\* BMT Static tool Holders can be supplied as per customer drawing

**RADIAL MULTIPLE TOOL HOLDER TYPE-1**

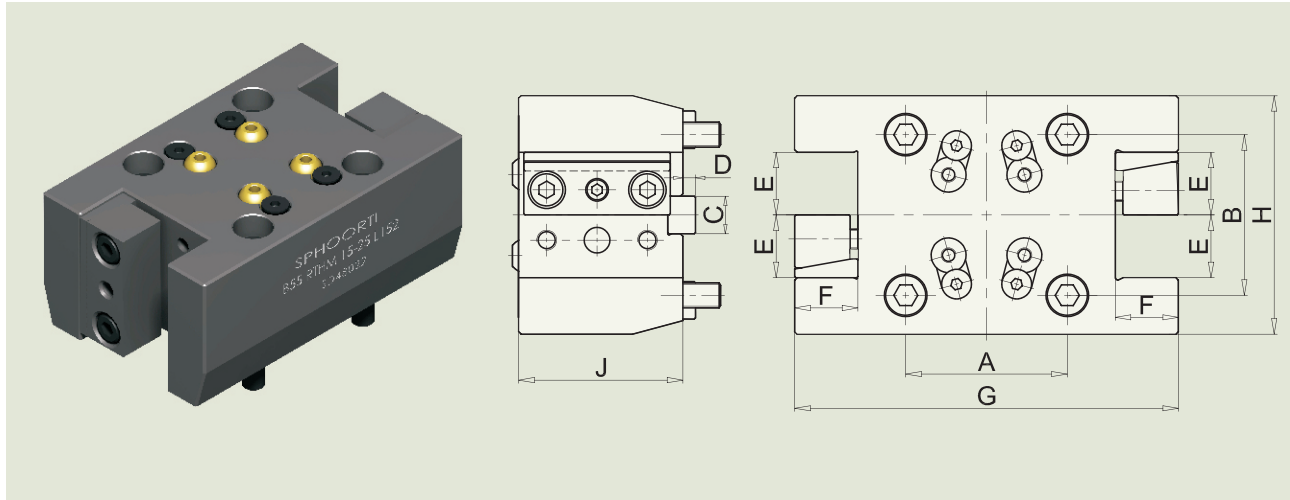

CODE	ITEM ID	A	B	C	D	E	F	G	H	J
B45-RTHM 15-20 L132	SD48236	58	58	15	5	20	20	132	75	60
B55-RTHM 15-25 L152	SD48022	64	64	15	5	25	25	152	95	65
B65-RTHM 18-25 L152	SD48023	70	73	18	5	25	25	152	96	75
B75-RTHM 25-32 L181	SD48438	90	90	25	6	32	32	181	112	85

**RADIAL MULTIPLE TOOL HOLDER TYPE-2**

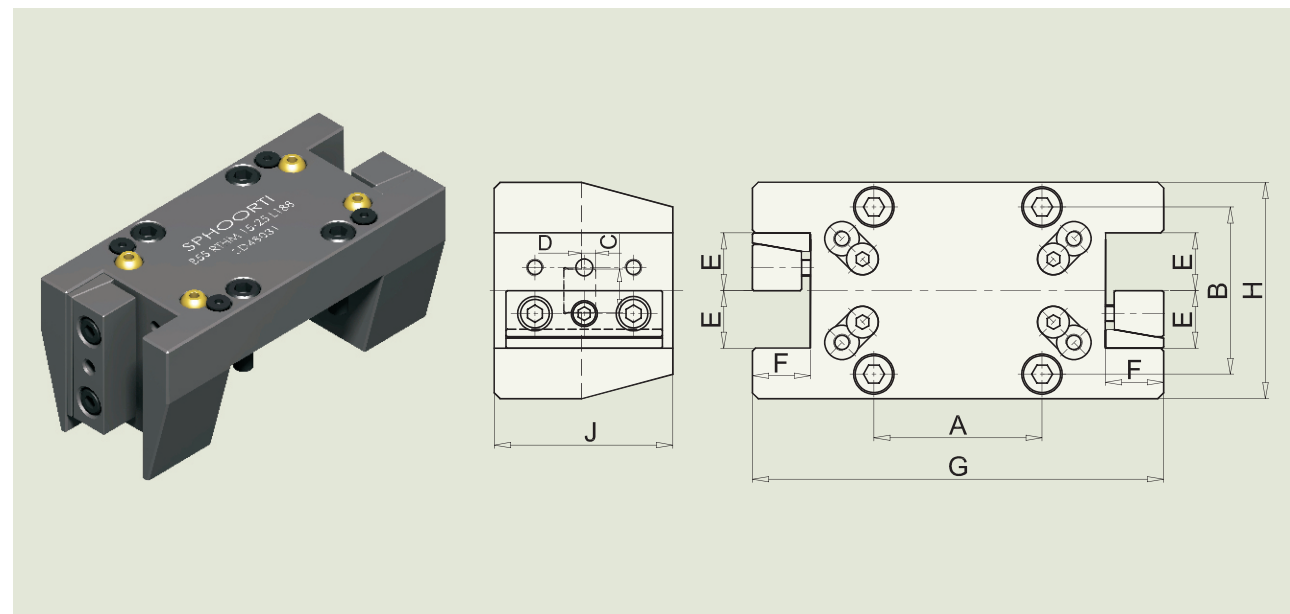

CODE	ITEM ID	A	B	C	D	E	F	G	H	J
B45-RTHM 15-20 L164	SD48259	58	58	15	5	20	20	164	75	66
B55-RTHM 15-25 L188	SD48031	64	64	15	5	25	25	188	86	80

\* BMT Static tool Holders can be supplied as per customer drawing

## OUR OTHER PRODUCTS

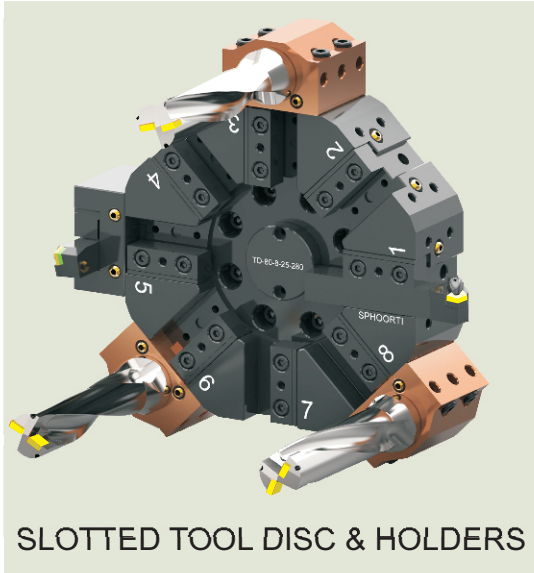

SLOTTED TOOL DISC & HOLDERS



VDI TOOL DISC & HOLDERS

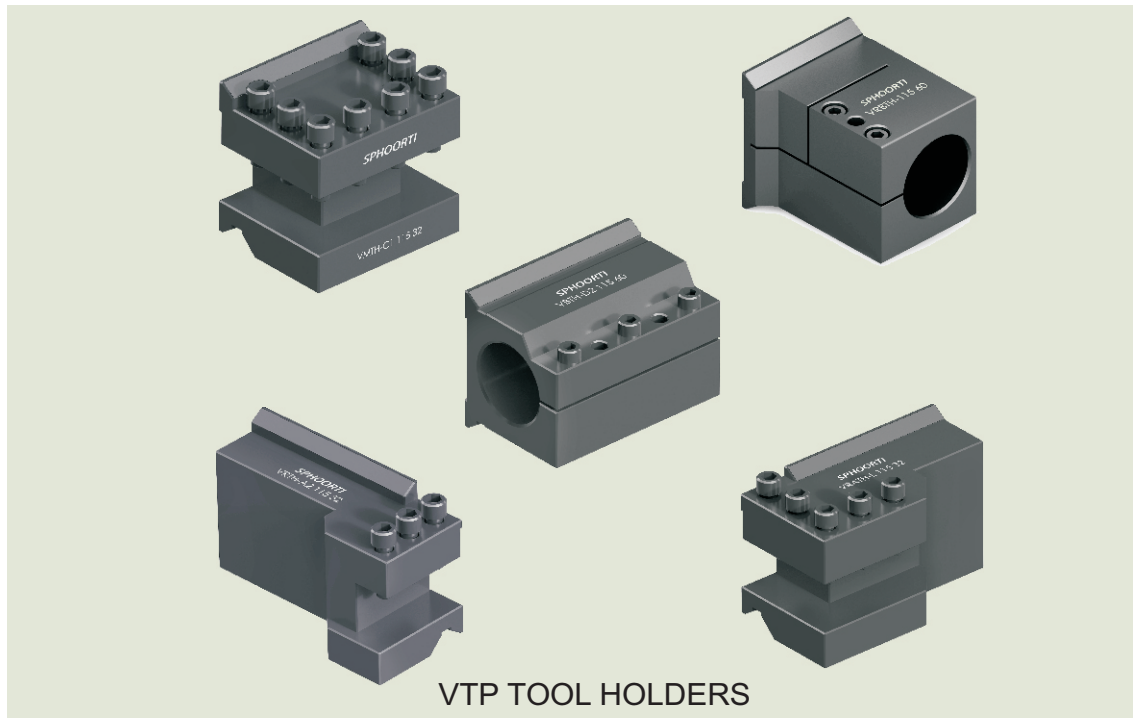

VTP TOOL HOLDERS

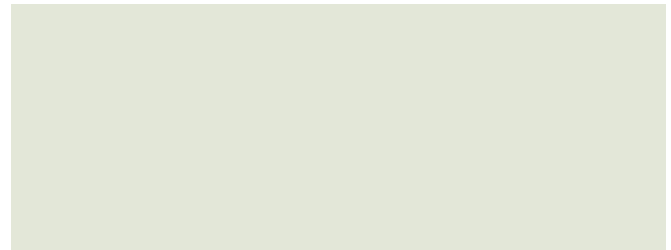

Sphoorti Machine Tools Pvt. Ltd.  
# 18, Plot No. 467 - 469, 12th Cross, IV Phase  
Peenya Industrial Area, Bangalore - 560 058. INDIA.  
Ph. : +91 80 4127 2768, Fax : +91 80 4117 1589  
E-mail : [info@sphoorti.com](mailto:info@sphoorti.com)  
URL : <http://www.sphoorti.com>